

STEP BY STEP GUIDE



- Step 1.** Measure the dimensions of your existing kitchen space (length, width and ceiling height) noting the location of any windows and doors.
- Step 2.** Use these measurements to draw up a rough plan of your kitchen on the attached graph paper. Note the location of existing plumbing, power and gas.
- Step 3.** Note down the dimensions of your existing and proposed kitchen appliances in the table provided.
- Step 4.** Call **A-Plan Kitchens** on **(02) 95163611** to arrange an appointment with one of our designers at the Camperdown showroom.
- Step 5.** With the help of your rough plan and appliance details, our experienced designers will draw up your new kitchen layout to scale and cost it in your choice of door and benchtop finishes.
- Step 6.** Upon payment of a deposit, **A-Plan** will check measure your kitchen space and provide you with a copy of the plan. The manufacture of your kitchen can then commence. This takes around 4-6 weeks.
- Step 7.** When your kitchen is ready, **A-Plan** will arrange delivery to your home in a modular, flat pack with all components numbered and labelled. If you're not confident assembling the kitchen yourself, we can recommend an experienced installer to do the job for you. Generally, the installer can arrange a plumber and electrician and co-ordinate these services.

ROUGH KITCHEN PLAN



A scale drawing is not required – just put down over-all room measurements and mark the position of existing doors and windows as well as stove and sink locations.

Sample 1

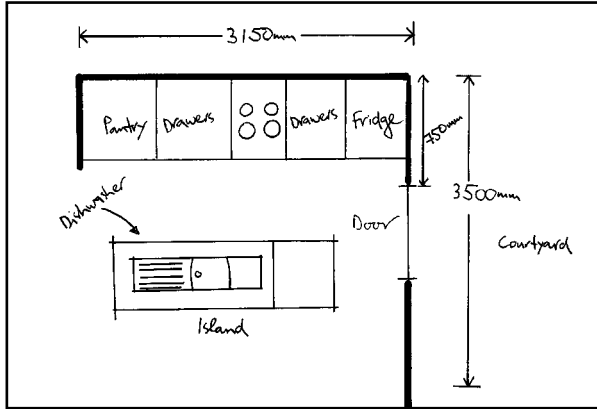

Sample 2

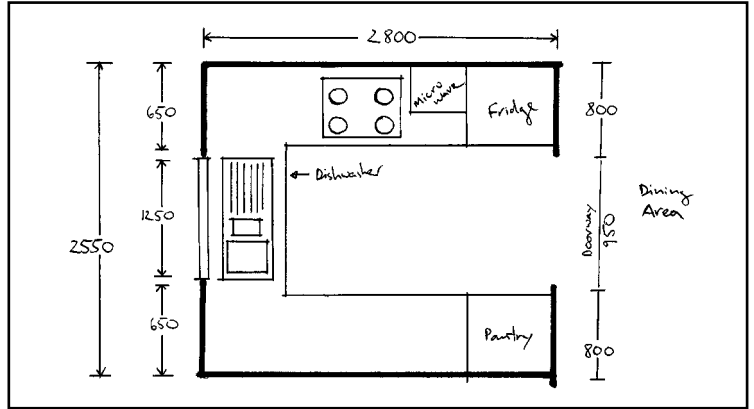

Grid area for drawing a rough kitchen plan.

Room width:
Room length:
Ceiling height:

APPLIANCE CHECK LIST



Dimensions of:	Height	Width	Depth
Fridge			
M/Wave			
Rangehood			
Hot Plate			
U/B Oven			
Wall Oven			
Upright Stove			
Dishwasher			
Sink			
Other			

A-Plan Kitchens

208 Parramatta Rd, Camperdown NSW 2050

Phone 02 9516 3611 • Fax 02 9557 1323 • Email enquiries@aplan.com.au

Terley Furniture Pty Ltd. (ACN 000 406 664)